

Manual King Pin Press

90150

**TIGER
TOOL**

Have What It Takes

Safety Warning

Read all instructions and safety warnings prior to operation. Failure to do so could result in equipment damage, personal injury or even death.

CAUTION: USE REPLACEMENT PARTS AND ACCESSORIES PROVIDED BY TIGER TOOL ONLY. ALL REPLACEMENT PARTS AND ACCESSORIES ARE AVAILABLE. KEEP HYDRAULIC COUPLER PROTECTED WHEN NOT IN USE. DUST CAPS SHOULD BE USED ON COUPLERS WHEN NOT IN USE TO AVOID CONTAMINANTS FROM ENTERING THE HYDRAULIC CYLINDER AND POWER SOURCE. THIS PRACTICE WILL HELP TO EXTEND THE LIFE OF THIS PRODUCT AND ENSURE CONTINUED CONSISTENT OPERATION.

- **Stay Alert!** Watch what you are doing and use common sense when operating this tool.
- Inspect product for damage prior to using; do not use if product is in unsafe condition.
- Do not operate tool while under the influence of drugs, alcohol or medication.
- Always use safety equipment to prevent injuries. Approved face and eye protection must always be worn by the operator, as well as others in the work area.
- Do not overreach. Keep proper footing and balance at all times.
- Dress properly. Do not wear loose clothing or jewelry. Keep your hair, clothing and gloves away from moving parts.
- Keep your work area clean and well lit.

NOTE: HAMMERING THIS TOOL WILL VOID YOUR WARRANTY.



View demonstration videos and a complete product list at tigertool.com

Technical Support
1.800.661.4661

Manual King Pin Press

90150

**TIGER
TOOL**

Have What It Takes

Operating Instructions

Note: Both 1.25" diameter forcing screws share the same anvil.

Note: The 0.875 diameter forcing screw is designed for use with up to a 1/2" impact wrench. The 1.25" diameter forcing screw is designed for use with up to a 1" impact wrench.

- 1 Remove the hub
- 2 Remove the cotter pin and castle nut from the tie rod end and make sure tie rod end threads are clean and free of damage.
- 3 Select the corresponding sized Tie Rod End Remover. Thread on the tool until it bottoms out, then back it off one complete turn. **(Figure 1)**
- 4 Strike the top of the tool with a hammer, tie rod will "pop" loose. Remove the tool.
- 5 Remove the king pin wedge pins.
- 6 Place the Screw Plate over top of the king pin and insert two of the 5/8"x15" screws (item No. 3) through the outside holes. If the king pin is smaller than 1.25" diameter, you will need to install the 0.875" reducer (item No. 14) in to the Screw Plate and torque both 1/2"-13 SHCS bolts (item No. 17) to 80 ft-lbs. **(Figure 2)**
- 7 Position the clearance plate under the bottom of the king pin and thread the two 90150-9 screws in to outside holes. Note: For 2 1/4" king pins, the Tiger Tool 90152 Clearance Plate must be used. Please refer to tigertool.com for more information. **(Figure 3)**

Note: If servicing an Isuzu NPR or GMC/Chevrolet W Series truck, place the Tiger Tool 90151 adapter (not included) over top of the clearance hole on the plate. Please refer to tigertool.com for more information.

- 8 Using **Figure 4** as reference, place the torque arms over top of the Clearance Plate so you can thread the inner two (90150-9 5/8"x15" screws) through the arms and into the Clearance Plate. The torque arms should have the 90150-10 Tap Bolts installed so that the heads are facing towards the axle. In some applications, it may not be possible to install both or any Torque Arms. Ensure careful attention is given when using the tool with one or no Torque Arms.



View demonstration videos and a complete product list at tigertool.com

Technical Support
1.800.661.4661

Manual King Pin Press

90150

**TIGER
TOOL**

Have What It Takes

Operating Instructions

- 9 With an impact wrench, tighten all 4 (90150-9 5/8"x15 screws) until the clearance plate becomes snug against the bottom of the axle. Alternate tightening of the 4 bolts ensuring the clearance plate and Screw Plate are parallel and concentric to the king pin. **(Figure 5)**
- 10 Lubricate the Forcing Screw with clean motor oil and hand thread into Screw Plate until the Forcing Screw anvil touches the king pin.
- 11 Tighten the Tap Bolts in the Torque Arms against the axle until they are hand tight, this will keep the press assembly from twisting under load. **(Figure 6)**
- 12 Apply force to the Forcing Screw until the king pin falls through the bottom of the Clearance Plate. **(Figure 7)**
- 13 Clean and lubricate tool and place back into case.

Here at Tiger Tool, your satisfaction is our number one priority. Should you have any questions about this or any of our products, please call us at 1.800.661.4661.

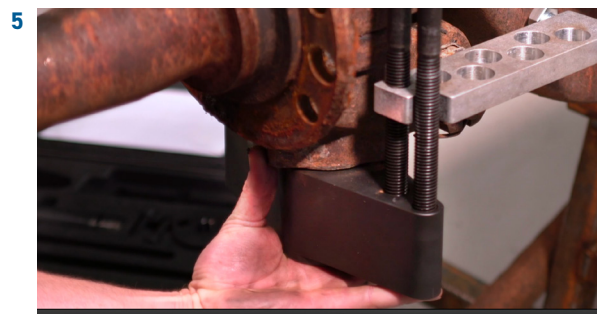

View demonstration videos and a complete product list at tigertool.com

Technical Support
1.800.661.4661

Manual King Pin Press

90150

**TIGER
TOOL**

Have What It Takes

Parts Breakdown

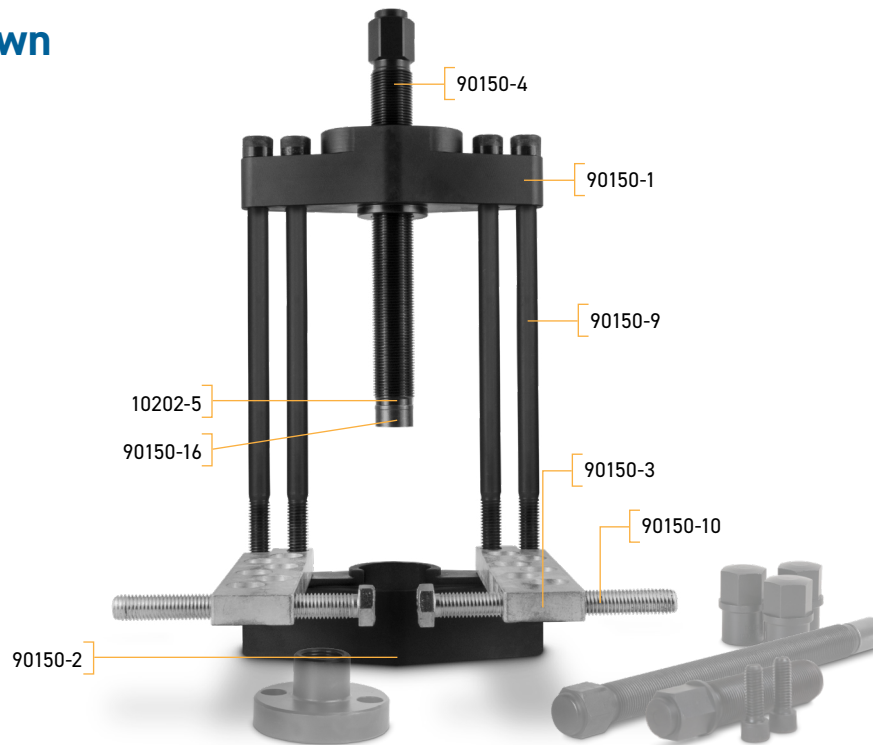

Part Number	Description	Qty.
90150-4	1 1/4" Forcing Screw – Long	1
90150-1	Screw Plate	1
90150-9	5/8" x 15" SHCS	4
10202-5	O-Ring	1
90150-16	Anvil 1 1/4"	1
90150-3	Torque Arm	2
90150-10	Tap Bolt 5/8" – 11 x 6	2
90150-2	Clearance Plate	1



View demonstration videos and a complete product list at tigertool.com

Technical Support
1.800.661.4661

Manual King Pin Press

90150

**TIGER
TOOL**

Have What It Takes

Parts Breakdown

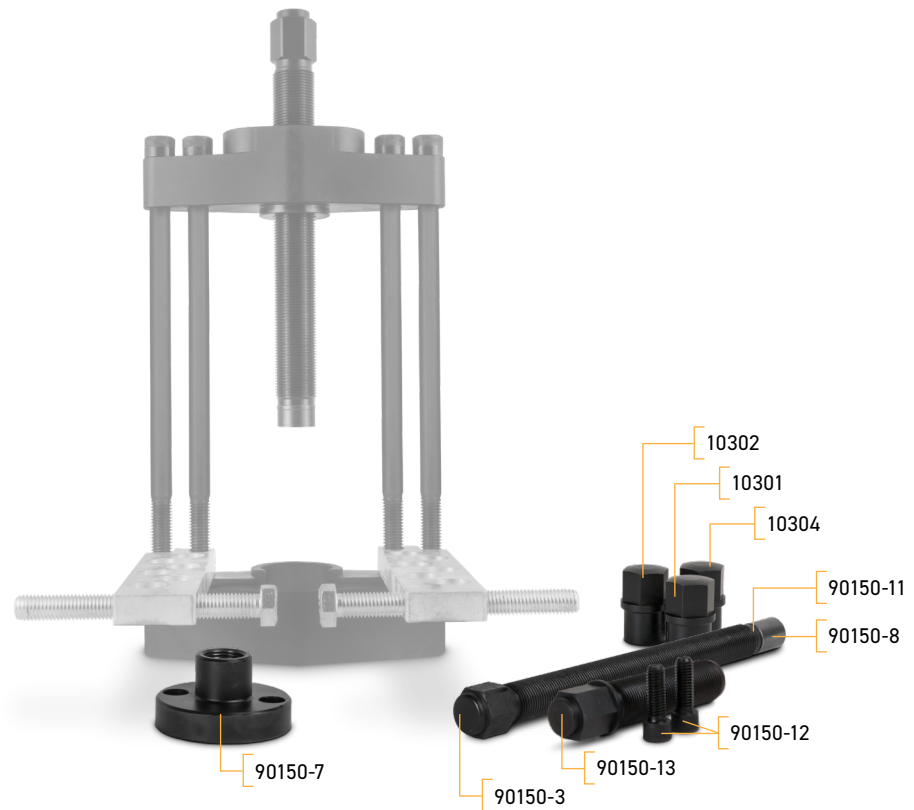

Part Number	Description	Qty.
10301	Tie Rod End Remover - 7/8" - 14	1
10302	Tie Rod End Remover - 3/4" - 16	1
10304	Tie Rod End Remover - M20 x 1 1/2"	1
90150-11	O-Ring	1
90150-8	0.875" Anvil	1
90150-7	0.875" Reducer	1
90150-3	0.875" Long Forcing Screw	1
90150-13	1 1/2" Short Forcing Screw	1
90150-12	1/2" - 13" x 1.5" SHCS	2



View demonstration videos and a complete product list at tigertool.com

Technical Support
1.800.661.4661